



Rack Cooling Unit

All-In-One Rack Cooling System

Right Power all-in-one rack cooling system integrated with air conditioner, UPS system, battery, PDU and real-time monitoring software. The server rack is a 42U mounting height, and can be used to store servers, UPS, battery pack, and IT servers.

The controller is an LCD touch screen, and the parameters are set through the interface options. The display screen is used to display the UPS status, air conditioning status, micro environment, smart PDU, data history, system configuration, and alarm history. All control and alarm settings in the system can be programmed. The cooling system intelligently adjusts its cooling capacity from 900W to 3500W using a DC inverter-equipped air conditioner for high-efficiency cooling operation.

The all-in-one cooling rack provide adaptability, flexibility, and cost-effective solutions to your specific data center needs. It is suitable to be used in indoor environments such as computer rooms or data centers.

Features

- All-in-one rack cooling system integrated air conditioner, UPS, battery, PDU and real-time monitoring software
- Plug and play easy and rapid deployment
- R410A refrigerant for environmental protection
- Sealed cabinet design for sustainable cooling and noise reduction
- Auto-adjust cooling capacity from 900W to 3500W
- Air conditioner with DC inverter design for high efficiency operation



Rack Cooling Unit

System Outlook

1. Emergency Cooling Fan
2. HMI Display
 - 10" Touch LCD Screen
 - UPS Status Monitoring & Management
 - Temperature & Humidity Monitoring
3. Anti-fog Double Glass
4. Power Distribution Unit
 - OU with C13 x 15
 - Vertically On The Back Of The Chassis
5. Emergency Cooling Fan
6. Security & Accessories
 - Smoke Detector
 - LED Lighting
 - Environmental Monitoring Device
7. Cabinet
 - 42U x 600 x 1200mm
 - Sealed Design
 - Surface Painting For Anti-Rust, Water-proof and Anti-Corrosion
 - Removable Side Panel
8. Switch Panel
 - 3U
 - Integrated All Switches For Input, Output, Manual Bypass and PDU
9. UPS
 - 2U / 3U
 - Alternative UPS Is Available
10. Air Conditioner
 - 5U
 - 3.5KW Cooling Capacity
 - R410 Refrigerant
 - DC Inverter Design
 - Redundant Cooling Fan



Front View (Open)

Front View (Closed)

Rack Cooling Unit

Monitoring Software

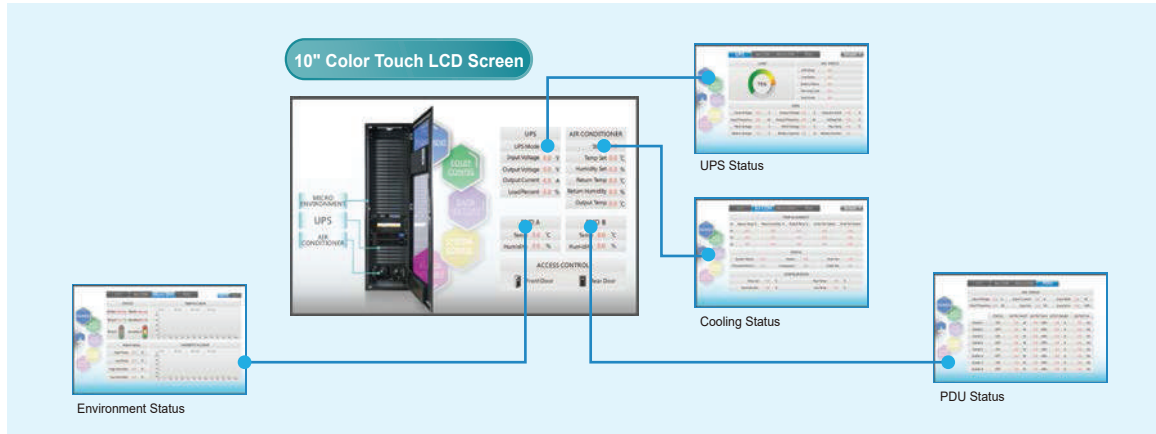

Cooling Ventilation System

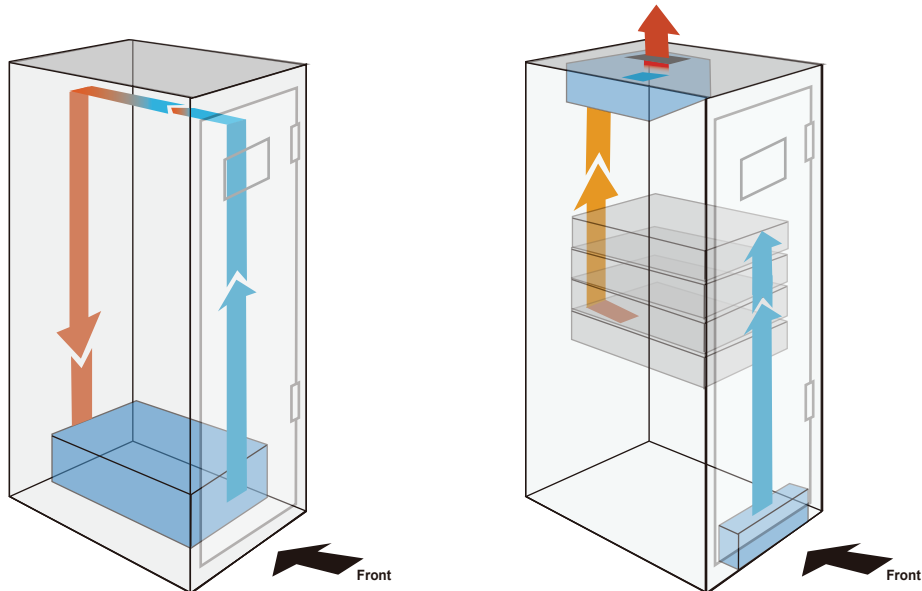

Optional Accessories



Integrated Camera on LCD Panel



Magnetic Door Locker



Alarm Belcon



1U Meter PDU



Leakage Sensor



Alternative UPS Selections



For Space Saving with Maximum UPS Capacity

- Rack / Tower 10KW (2U)
- 192Vdc Battery Cabinet (2U)



For Easy Maintenance

- M+ QBits Modular UPS (3U)

Technical Specification:

AIR CONDITIONER			
Maximum Cooling Capacity	3.5KW (Adjustable, 900W ~ 3500W)		
Power Supply	220V/50Hz Single Phase		
Air Flow	700CHM		
Dimension, D x W x H (mm)	740 x 438 x 222 (5U) for In-Rack Unit		
	285 x 763 x 285 for External Compressor		
Refrigerant Type	R410A		
Design Lifetime	10 Years		
Operation Environment	Humidity	0 ~ 90% Relative Humidity	
	Temperature	-15~45°C	
PDU			
Standard	PDU with IEC C13 x 15		
Optional	1U meter type PDY for 8 controllable outlets		
Switches Box	3U with MCBs for Main Power / UPS / AC / Manual Bypass / Light and SPD		
MONITORING			
Display	10" Colour Touch LCD		
Standard Accessory	Temperature / Humidity / Smoke Sensor / LED Lighting		
Optional Accessory	Integrated Camera / Magnetic Door Locker / Leakage Sensor / Alarm Belcon		
UPS SELECTION			
Phase	1/1, 3/3, 2/2 or 3/1	1/1	
Capacity	10KW	6KW	10KW
Dimension, D x W x H (mm)	678 x 418 x 132 [3U]	530 x 438 x 88 [2U]	580 x 438 x 133 [3U]
Net Weight (kgs)	20.5	15	18
Battery Pack Dimension, D x W x H (m)	678 x 418 x 132 [3U]	715 x 438 x 88 [2U]	715 x 438 x 88 [2U]
Features	* Modular online UPS * Hot-swappable design	* Space saving. UPS with battery pack only 4U	
CABINET			
Dimension, D x W x H (mm)	1200 x 600 x 2000 [42U]		
Bearing Load (kgs)	1500		
IP Rating	IP40, with Ventilation Fan Holes on the Cabinet Top Side		

*Specification subjects to change without prior notice